

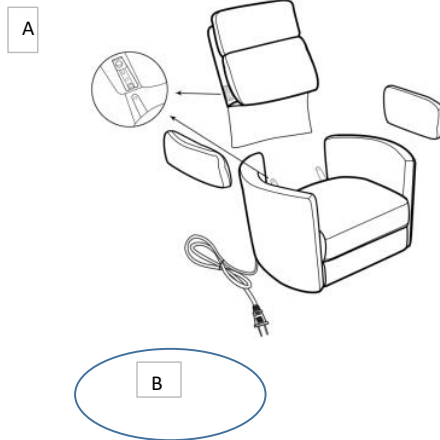

Step 1:  
Parts list on the right

Note: Power cord is tied on the mechanism under the seat

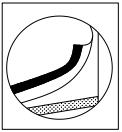
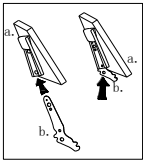

You can find this power cord is tied well on the mechanism which under the seat.

Note:  
1: To help prevent shock and or damage to your product only plug the power cord into a grounded outlet.  
2: Do Not Plug the power source into a power outlet until your product is completely assembled and position where you intend to use it

Caution:  
Read the Operating Instruction supplied before operating your power mechanized equipment.  
Do not allow children to play on or operate this power mechanized equipment

## ASSEMBLY INSTRUCTIONS RADIUS RECLINER

PARTS LIST:		Sofa	Loveseat	Recliner
A	BACK			1
B	SEAT			1
C	Power Cord (Pre-attached)			1

Step 2: Attached the KD bac to the base frame by aligning the brackets with the mechanism post as seen at the left. After agligning both sides, push firmly in a downward motion until you hear a clicking noise. The noise indicates the back is locked to the base frame. Please make sure both sides are locked in position. Attached the outside backflap to the bottom of the wooden raik by tuck the velcro. (As shown on right)

Step 3:  
Connect the power cord to a power source.

Picture shown for reference only.